

556 Fundamental Way

Cottage Grove, WI 53527

TIM O'BRIEN
homes

Call Today
(608) 401-4769

UNDER CONSTRUCTION



PRICED AT

\$454,900

Neighborhood: Shady Grove

3190 Drumlin Rdg Dr, Cottage Grove, WI

 3 Bedrooms

 2.5 Bathrooms

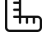
 1,847 Sq. Ft.

 2 Car Garage

Come home to the picturesque community of Shady Grove. Move-In Ready Oct. 2024. This twin home boasts 1,847 square feet of thoughtfully laid out living space. Enjoy open concept living on the main level with a sunny kitchen and living room with a cozy fireplace. You'll find a covered porch in the rear overlooking your landscaped yard. Upstairs you'll find a large primary bedroom with en-suite bath and two walk-in closets. The upper level also offers two additional bedrooms, each with walk-in closets, as well as a conveniently located second floor laundry room. Energy efficient, New Construction from Tim O'Brien Homes.

The information, text, graphics and links provided herein are provided by Tim O'Brien Homes as a convenience to its customers. Tim O'Brien Homes does not guarantee the accuracy or completeness of the information, text, graphics, links and other items contained on this website or any other website. All prices, promotions and specifications are subject to change at any time without notice based on the discretion of Tim O'Brien Homes.



556 Fundamental Way

Cottage Grove, WI 53527

Call Today
(608) 401-4769

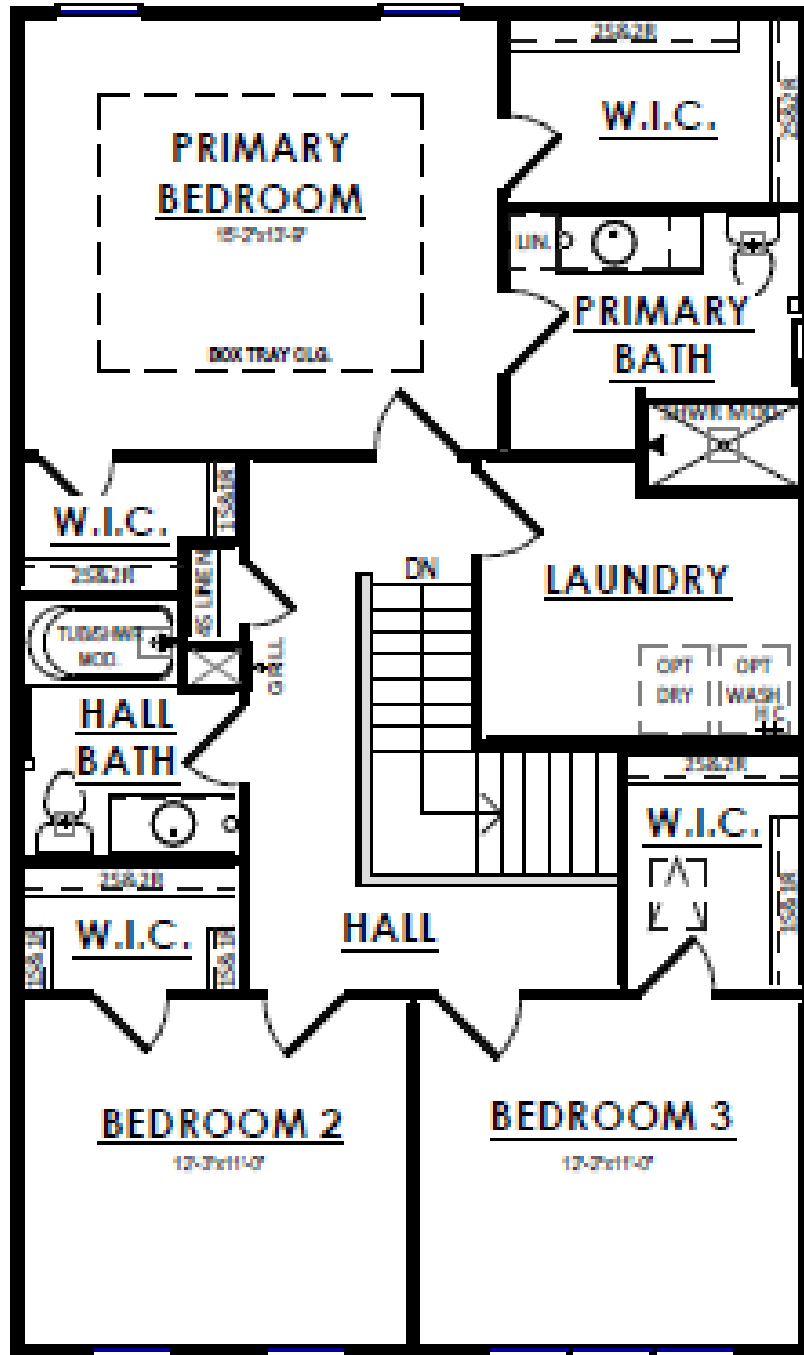

556 Fundamental Way

Cottage Grove, WI 53527

Call Today
(608) 401-4769

